



Modular heat, vent and light solutions.



IXL
innovating since 1858



5 year in-home
warranty on unit

How to get the best extraction results from your exhaust fan checklist

The following is a checklist to ensure that the exhaust product that you install will perform at its optimal level. As every home is different, the installation of the product varies, depending on the installer, room size and roof cavity configuration.

- To prevent moisture build up, bathrooms need a fan with the capacity to change the air volume of the room at least 15 to 20 times per hour. To ensure that the fan is working correctly, there needs to be air flow coming into the bathroom via an open window or from under a door. (FIG.1) Energy ratings under the Australian Building Code may require doorways to the bathroom to be sealed and this combined with a sealed window may reduce the effectiveness of any installed exhaust fan. No matter what brand.

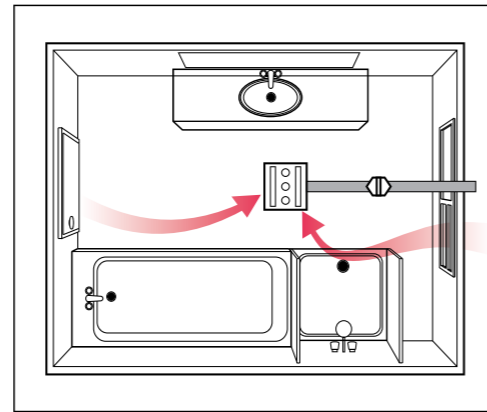

FIG.1

- Check that your ducting is pulled taut in the cavity. If there are any kinks or bends in the ducting, the in-line exhaust fan will not operate effectively. (FIG.2)

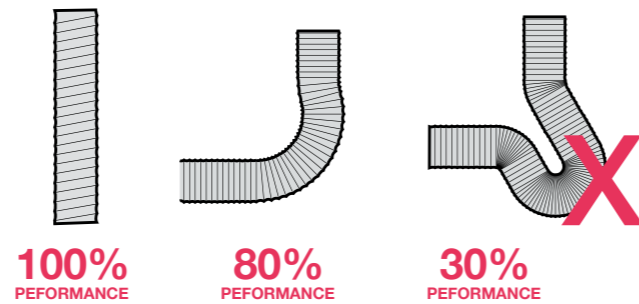

FIG.2

- Our online calculator (FIG.3) provides information on how to determine what level of extraction you need depending on the room type and size.
- To ensure adequate ventilation include in your calculations spaces that directly flow into the bathroom such as large, open plan bedrooms, laundries or walk-in robes.

ixlappliances.com.au/extraction

FIG.3

- Bathrooms that have high ceilings, are larger than average (greater than 7.5 m²), or that have an open shower may all require additional ventilation.
- If there is an **open shower, we recommend an additional IP-rated fan above the shower area** regardless of the size of the bathroom. An IXL Eco Ventflo or Tastic Neo Vent Module would be suitable in this instance.

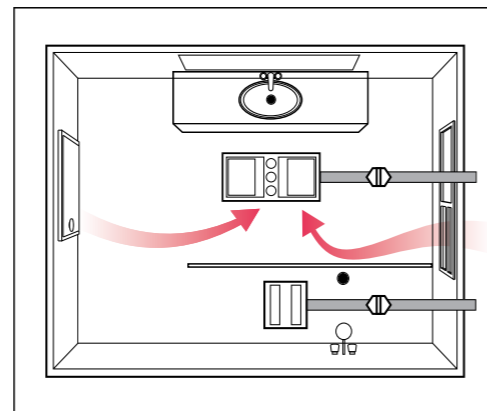
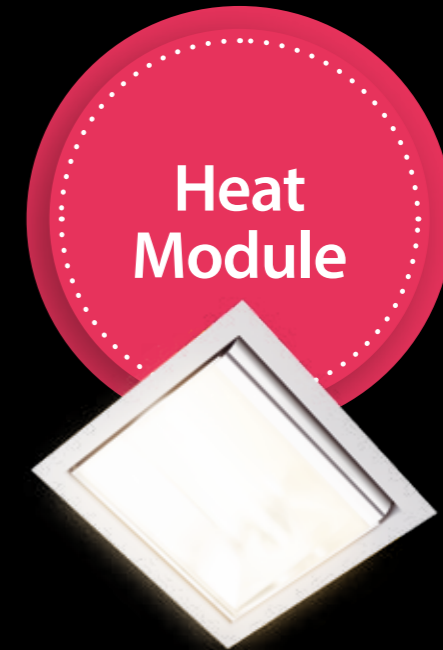

FIG.4



Neo and Neo Modules
Neo Technology
Neo Inspirations
Neo Vent Module
Neo Vent n Lite Module

pg 4
pg 6
pg 7
pg 8
pg 10

Neo Heat Module
Neo Single
Neo Dual
Neo Modules Specifications
Neo Specifications

pg 12
pg 14
pg 16
pg 18
pg 19

Modular Solutions with a simple elegant design

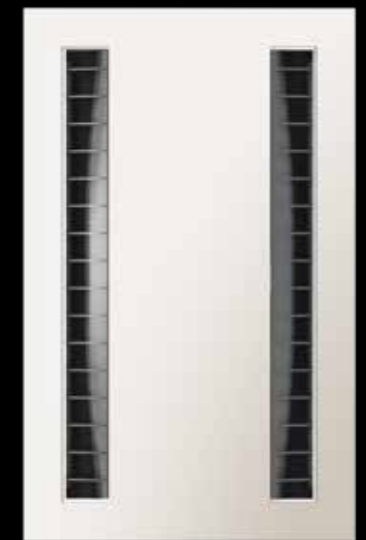

IXL has been innovating since 1858 and continues to lead the way in creating ingenious heat, light and ventilation solutions for Australian homes.

The new Tastic Neo Module collection upholds IXL's commitment to applying cutting-edge technology, contemporary design principles, and high quality manufacturing processes to create customisable options to suit any style, location or desired comfort level.

The Tastic Neo range is designed and manufactured by Sampford IXL proudly on the shores of Geelong, Australia, with each unit supported by an industry-leading 5 year, in-home warranty.

The Tastic Neo Model range includes:

- Vent Module** – A stylish choice for environments where there is existing heating and lighting.
- Heat Module** – This module allows you to position heating only where you need it.
- Vent n Lite Module** – With low energy LED lighting and powerful extraction this unit provides the perfect solution when heating is not required.



Halo Heat Technology

Tungsten halogen heating technology distributes infrared heat effectively across the body.

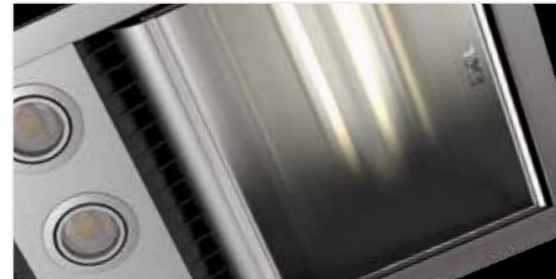

The Tastic® Neo features specially-designed, frosted, toughened glass to diffuse heat effectively. To maximise comfort levels, the Tastic® Neo Dual can be operated on one or two heat lamp settings.



Ventair In-Line Extraction

To extract steam from your bathroom, the fully-ducted Ventair removes air to the outside and seals when not in use.

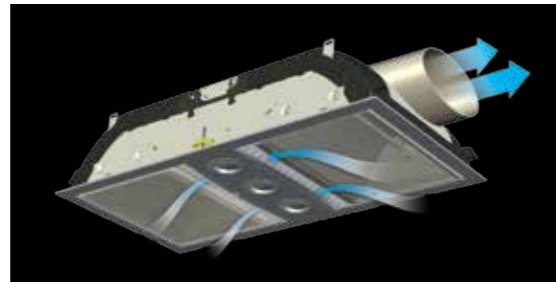

Side ducting allows versatile installation into multi-storey dwellings that have limited space between the ceiling and the floor above. The unit vents directly outside, making it perfect for 5 Star homes.



LED Omni Lighting

Gimbal-mounted downlights allow directional lighting towards the areas light is required.



Gimbal-mounted, energy saving LED downlights allow directional lighting.



warranty on heat lamps and in-line exhaust



in-home warranty on unit



The new Tastic Neo and Neo Modules collection from IXL allow perfectly blissful bathroom environments to be fashioned.

These innovative units enable heat, light and ventilation to be customised to enhance the comfort level, ambience and aesthetics of any designed space.



Vent Module

Position an IXL Vent Module over the shower, or in the laundry or powder room to banish odours and water vapour effectively without the need for a bulky extraction fan.

Tastic Neo Vent Module



Powerful in-line extraction – 375 m³/h suitable for bathrooms up to 18.75 m³ when used on its own.



These units can be installed directly over a shower – IPX4 rated.

35101 White

35102 Silver

- Ventair in-line extraction – ducted exhaust fan*
- Rated IPX4 – can be installed directly above shower
- Back draught flaps
- External grille supplied

- Aluminium flexi ducting – 6 m x 150 mm dia.
- **2 year warranty on in-line exhaust**
- **5 year in-home warranty on unit**
- **Australian made**



* Additional ventilation may be required for large bathrooms. Please note that if the bathroom flows into another open space such as a bedroom or walk-in robe then these areas need to be included in your calculations. If there is an open shower, we recommend an additional IP-rated fan above the shower area regardless of the size of the bathroom.



Vent n Lite Module

Powder rooms, butler's pantries and laundries all benefit from increased ventilation and energy efficient task lighting. IXL's Vent n Lite Module makes it easy to position ventilation and task lighting wherever you need it.

Tastic Neo **Vent n Lite Module**



Powerful in-line extraction – 375 m³/h suitable for bathrooms up to 18.75 m³ when used on its own.



Bright, instantaneous light is provided by 3 x 7 W energy saving LED downlights.

- 34101 White**
- 34102 Silver**



- Omni Lighting – 3 x 7 W LED GU 10 gimbal-mounted downlights
- Ventair in-line extraction – ducted exhaust fan*
- Back draught flaps
- External grille supplied

- Aluminium flexi ducting – 6 m x 150 mm dia.
- **2 year warranty on in-line exhaust**
- **5 year in-home warranty on unit**
- **Australian made**

* Additional ventilation may be required for large bathrooms. Please note that if the bathroom flows into another open space such as a bedroom or walk-in robe then these areas need to be included in your calculations. If there is an open shower, we recommend an additional IP-rated fan above the shower area regardless of the size of the bathroom.



Heat Module

A Neo Heat Module gives you the flexibility to position radiant heat anywhere you need it. Ideal for bathrooms, walk in robes and laundries.

Tastic Neo **Heat Module**



800 W tungsten halogen heating lamp.



Specially designed frosted glass diffuses the infrared heat effectively.

- 36111 White
- 36112 Silver



- Halo Heat Technology – 1 x 800 W tungsten halogen infrared heat lamp
- Suits ensuite and mid-sized bathrooms with ceiling height to 2.4 m*

- **2 year warranty on heat lamp**
- **5 year in-home warranty on unit**
- **Australian made**

* If ceiling height is greater than 2.4 m, more than one heat module may be required. NB: All Tastic products are only designed and approved for use in horizontal applications. See instructions for full details.



**Heat.
Vent. Light.**

The perfect choice for single and multi-storey homes. The in-line extraction system vents directly to outside the home. Tungsten heating lamps with improved efficiency and directional downlights give you a light-filled, evenly heated and well ventilated bathroom.

Tastic Neo Single



Features an 800 W tungsten halogen heating lamp, a powerful in-line extraction system and directional LED downlights.



Powerful in-line extraction – 346 m³/h suitable for bathrooms up to 17.3 m³ when used on its own.

31111 White

31112 Silver

- Halo Heat Technology – 1 x 800 W tungsten halogen infrared heat lamp
- Omni Lighting – 3 x 7 W gimbal-mounted LED downlights
- Ventair in-line extraction – ducted exhaust fan*
- Suits ensuite and mid/large-sized bathrooms with ceiling height to 2.4 m**
- Back draught flaps
- External grille supplied
- **2 year warranty on heat lamp**
- **2 year warranty on in-line exhaust**
- **5 year in-home warranty on unit**
- **Australian made**



* Additional ventilation may be required for large bathrooms. Please note that if the bathroom flows into another open space such as a bedroom or walk-in robe then these areas need to be included in your calculations. If there is an open shower, we recommend an additional IP-rated fan above the shower area regardless of the size of the bathroom.** If ceiling height is greater than 2.4 m, more than one heat module may be required. NB: All Tastic products are only designed and approved for use in horizontal applications. See instructions for full details.

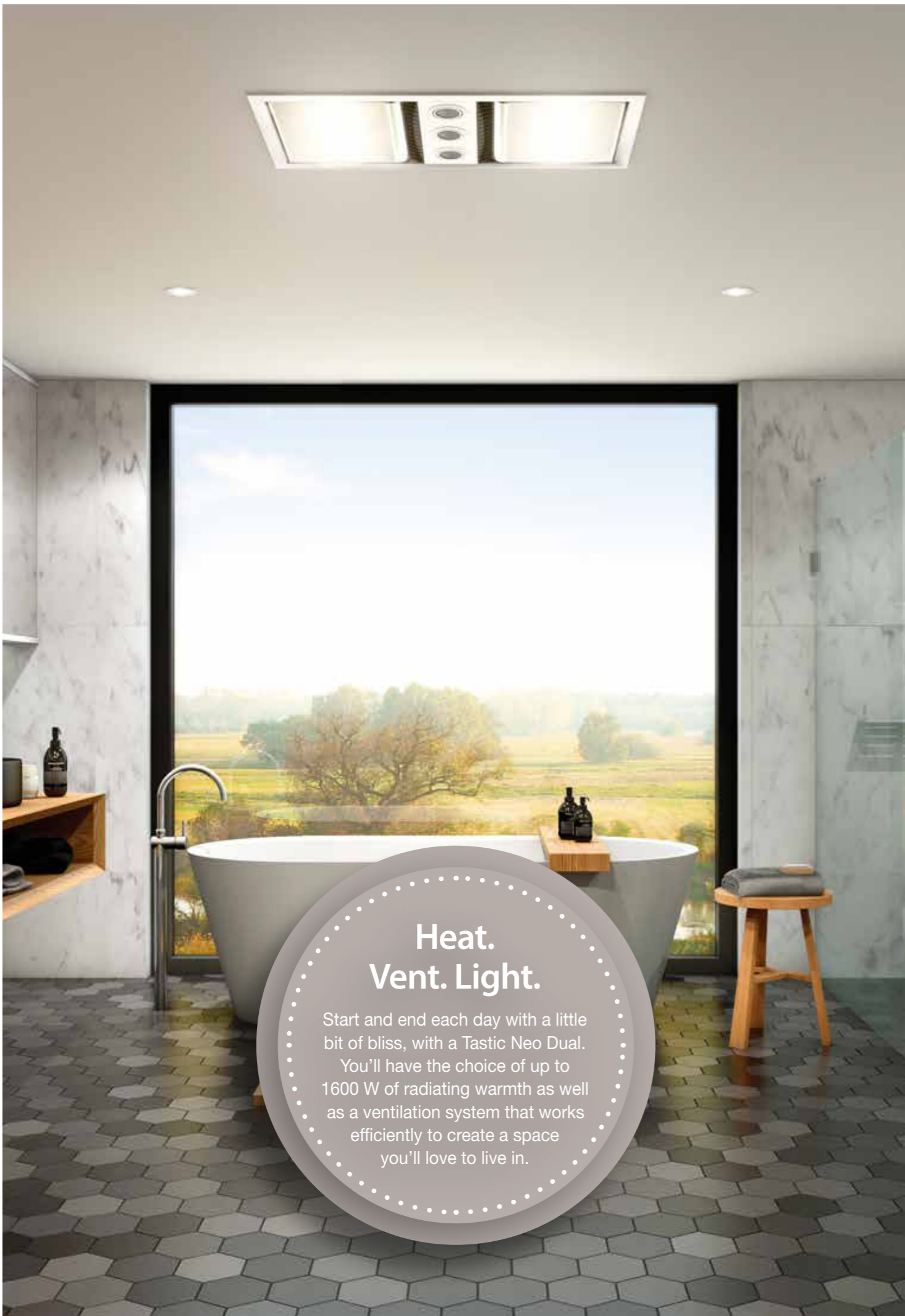

**Heat.
Vent. Light.**

Start and end each day with a little bit of bliss, with a Tastic Neo Dual. You'll have the choice of up to 1600 W of radiating warmth as well as a ventilation system that works efficiently to create a space you'll love to live in.

Tastic Neo Dual



The premium Neo heat, vent and light model features all Neo technologies with an additional 800 W heating lamp.



Powerful in-line extraction – 346 m³/h suitable for bathrooms up to 17.3 m³ when used on its own.

32111 White

32112 Silver

- Halo Heat Technology – 2 x 800 W tungsten halogen infrared heat lamp
- Omni Lighting – 3 x 7 W gimbal-mounted LED downlights
- Ventair in-line extraction – ducted exhaust fan*
- Suits ensuite and mid/large-sized bathrooms with ceiling height to 3.3 m
- Back draught flaps
- External grille supplied
- **2 year warranty on heat lamps**
- **2 year warranty on in-line exhaust**
- **5 year in-home warranty on unit**
- **Australian made**



* Additional ventilation may be required for large bathrooms. Please note that if the bathroom flows into another open space such as a bedroom or walk-in robe then these areas need to be included in your calculations. If there is an open shower, we recommend an additional IP-rated fan above the shower area regardless of the size of the bathroom. NB: All Tastic products are only designed and approved for use in horizontal applications. See instructions for full details.

Tastic Neo Modules Specifications & Comparisons

Tastic Neo Module SPECIFICATIONS	Neo Vent WHITE Hardwired	Neo Vent SILVER Hardwired	Neo Vent n Lite WHITE Hardwired	Neo Vent n Lite SILVER Hardwired	Neo Heat WHITE Hardwired	Neo Heat SILVER Hardwired
Model Number	35101	35102	34101	34102	36111	36112
Centre Lights	N/A	N/A	3 x 7 W LED GU 10	3 x 7 W LED GU 10	N/A	N/A
Halo Heat Technology	N/A	N/A	N/A	N/A	1 x 800 W tungsten halogen	1 x 800 W tungsten halogen
Wall Switch	Not Supplied	Not Supplied	Not Supplied	Not Supplied	Not Supplied	Not Supplied
Back Draught Flaps	Yes	Yes	Yes	Yes	N/A	N/A
Aluminium Flexi Ducting	6 m x 150 mm dia.	6 m x 150 mm dia.	6 m x 150 mm dia.	6 m x 150 mm dia.	N/A	N/A
Cut Out Size (mm)	332 (W) X 214 (D)	332 (W) X 214 (D)	332 (W) X 214 (D)	332 (W) X 214 (D)	332 (W) X 292 (D)	332 (W) X 292 (D)
Current Rating (Amps)	0.3	0.3	0.4	0.4	3.3	3.3
Watts (Fan in Brackets)	(75)	(75)	96 (75)	96 (75)	800	800
Min Clearance Required (mm)	245	245	245	245	75	75
Supply (Volts)	240	240	240	240	240	240
Fan Size (215 mm high)*	170 ducted blower Suits 150 dia. duct	170 ducted blower Suits 150 dia. duct	170 ducted blower Suits 150 dia. duct	170 ducted blower Suits 150 dia. duct	N/A	N/A
Capacity (m ³ /h – l/s)	375/104	375/104	375/104	375/104	N/A	N/A
Approx. Weight (kg)	1.5	1.5	1.9	1.9	2.6	2.6
Unit Dimensions (mm)	361 (W) x 237 (L) x 201 (D) (215 high for in-line fan)	361 (W) x 237 (L) x 201 (D) (215 high for in-line fan)	361 (W) x 237 (L) x 201 (D) (215 high for in-line fan)	361 (W) x 237 (L) x 201 (D) (215 high for in-line fan)	361 (W) x 320 (L) x 156 (D)	361 (W) x 320 (L) x 156 (D)

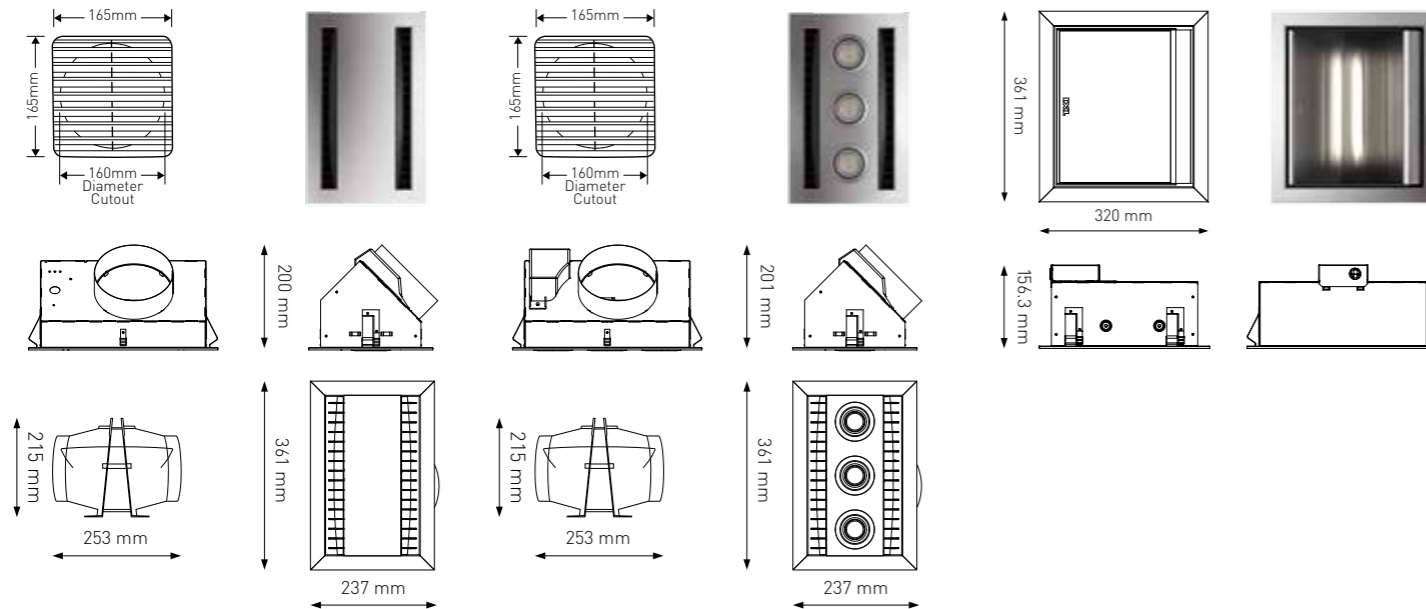

* Where the in-line blower unit is installed into an environment that has limited access and the unit needs to be serviced or replaced under warranty, a replacement blower will be supplied free of charge by IXL, however, all associated reinstatement charges will be borne by the owner.

Tastic Neo Specifications & Comparisons

Tastic Neo SPECIFICATIONS	Neo Single WHITE Hardwired	Neo Single SILVER Hardwired	Neo Dual WHITE Hardwired	Neo Dual SILVER Hardwired
Model Number	31111	31112	32111	32112
Halo Heat Technology	1 x 800 W tungsten halogen	1 x 800 W tungsten halogen	2 x 800 W tungsten halogen	2 x 800 W tungsten halogen
Remote Operation	No	No	No	No
Wall Switch	Supplied	Supplied	Supplied	Supplied
Cut Out Size	332 x 462	332 x 462	332 x 712	332 x 712
Current Rating (Amps)	3.6	3.6	7.0	7.0
Watts (Fan in Brackets)	875 (75)	875 (75)	1675 (75)	1675 (75)
Min Clearance Required (mm)	230 + 15 above unit	230 + 15 above unit	230 + 15 above unit	230 + 15 above unit
Supply (Volts)	240	240	240	240
Suits Ceiling Heights	up to 2.4m	up to 2.4m	up to 3.3m	up to 3.3m
Fan Size (230 mm high)*	170 ducted blower Suits 150 dia. duct	170 ducted blower Suits 150 dia. duct	170 ducted blower Suits 150 dia. duct	170 ducted blower Suits 150 dia. duct
Capacity (Litres/Sec)	96 (when using 6m of ducting)	96 (when using 6m of ducting)	96 (when using 6m of ducting)	96 (when using 6m of ducting)
Capacity (m ³ /Hour)	346 (when using 6m of ducting)	346 (when using 6m of ducting)	346 (when using 6m of ducting)	346 (when using 6m of ducting)
Approx. Weight (kg)	5	5	9	9
Unit Dimensions (mm)	358 (W) x 476 (L) x 166 (D)	358 (W) x 476 (L) x 166 (D)	358 (W) x 729 (L) x 166 (D)	358 (W) x 729 (L) x 166 (D)

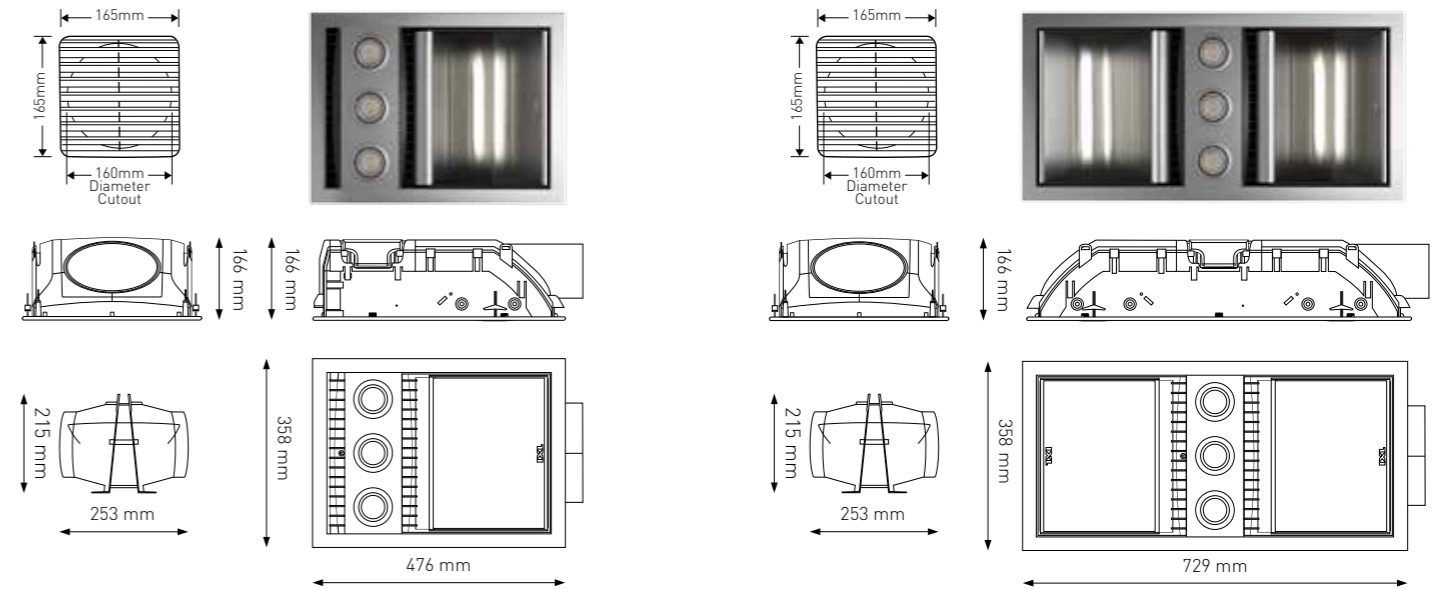

* Where the in-line blower unit is installed into an environment that has limited access and the unit needs to be serviced or replaced under warranty, a replacement blower will be supplied free of charge by IXL, however, all associated reinstatement charges will be borne by the owner.



Sampford IXL

SAMPFORD IXL PTY LTD
1 Wood Street, South Geelong,
Victoria 3220 Australia. Phone 1300 727 421
www.ixlappliances.com.au
info@sampfordixl.com.au
IXL and Tastic are registered
trademarks of Sampford IXL Pty Ltd.

SAMPFORD IXL NEW ZEALAND
310A Morningside Drive, Kingsland,
Auckland 1010. Phone 0800 727 421
service@sampfordixl.co.nz
IXL and Tastic are registered
trademarks of Sampford IXL Pty Ltd.

Whilst every effort is made to provide current information at the time this brochure was produced, continuing product improvements mean the enclosed specifications, images and literature may differ from what is actually available.